

DIMENSIONAL TOLERANCE IN[MM]					
C (Ø) (TYP)	D	L1	L	W	H
0.50	7.50	8.60	11.00	3.20	3.20
[12.70]	[190.50]	[218.44]	[279.40]	[81.28]	[81.28]

REVISION HISTORY			
REV	ECN	DESCRIPTION	PRODUCTION RELEASE
A			

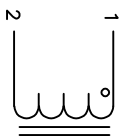

SCHEMATIC

- 7 BUILT TO ROHS COMPLIANCE
- 6 LABEL PART NUMBER AND REVISION WHERE SHOWN
- 5 VARNISH PART AND CURE

- 5 WRAP TAPE AROUND CORES WITH CORES AND INSULATOR PRE FORMED FLAT COPPER SHEETS
- 4 CONSTRUCTION:

- 3 WEIGHT: 16 LB (TYP)  
RECOMMENDED AMBIENT OPERATING TEMP: -40°C TO 105°C  
HI-POT TEST FROM WINDING TO CORE 5000VDC @ 2mA, 1 MIN  
INTERWINDING CAPACITANCE = 100pF (TYP) @ SRF  
|Z| = 13 KILLO-OHM TYP @ SRF  
SRF = 1.25 MHZ TYPICAL  
RATED CURRENT: 160 AMPS NOM, APPROPRIATE AIR FLOW NEEDED,  
DCR = 4.8 MILLIOHMS TYPICAL  
INDUCTANCE @ DC BIAS: SEE TABLE ON THE RIGHT.  
L = 150uH NOM, MEASURED AT 1 KHZ, 0.25V, ZERO DC BIAS  
SPECIFICATIONS @ 25°C:

- 2 VARNISH: UL APPROVAL MATERIAL  
SILICONE DOW CORNING OR EQUAL  
OUTER WRAP: 3M GLASS OR EQUAL
- 1 CORE: CWS PROPRIETARY E-CORE  
MATERIAL: UL RECOGNIZED

NOTES: UNLESS OTHERWISE SPECIFIED, READ FROM BOTTOM UP.

ANY TOLERANCE: THIS DIM. CAN VARY A LITTLE FROM PART TO PART.

\*TYP IN DIM. TABLE REFERS TO A NON-CRITICAL TYPICAL (AVERAGE) DIM. WITHOUT

CAGE CODE: 5DME2

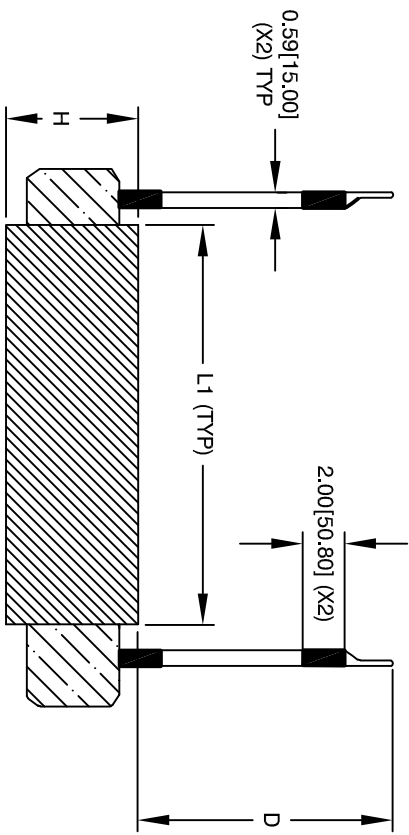

SIDE VIEW

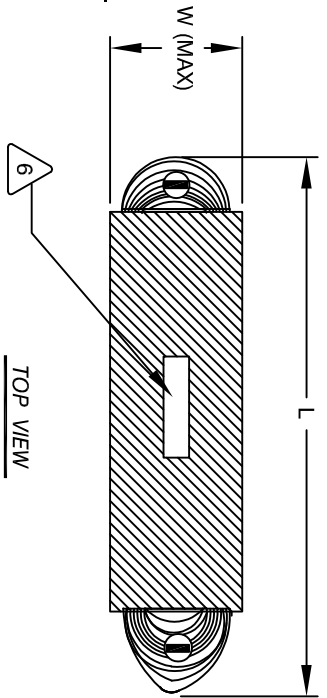

TOP VIEW

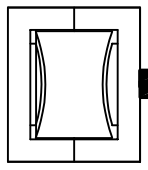

BACK VIEW

DC BIAS TABLE

DC-BIAS	L@1KHz (REF)
0A	153uH
10A	152uH
20A	152uH
30A	151uH
40A	150uH
50A	146uH
60A	146uH
70A	145uH
80A	143uH
90A	142uH
100A	138uH
150A	110uH
160A	106uH

PARTS LIST

UNLESS OTHERWISE SPECIFIED		DIMENSIONING AND TOLERANCE PER ANSI Y14.5M		ALL DIMENSIONS ARE IN INCHES AND [MILLIMETERS]	
DRWN	TN	07/09/25	ENGR	JL	07/09/25
CHECKD	JM	07/09/25	APPR	JL	07/09/25
TOLERANCE INCHES:		TOLERANCE METRICS:		ANGLE PROJECTION	
.XXX±.010 .XX±.020		.XXX±.25 .X±.51		AS SHOWN	
DO NOT SCALE DRAWING		AUTOCAD		X	
SOLIDWORKS		SIGN			
www.coilws.com		DATE		07/09/25	
sales@coilws.com		ENGR		JL	
Coil Winding Specialist, Inc.		APPR		JL	
353 W GROVE AVE		SCALE		NOT TO SCALE	
ORANGE, CA 92865		TITLE:		Medium Current Inductor	
		SIZE [DIM. NO.]		CWS-MCS-13210	
		SHEET		1 OF 1	
		REV		A	